

CERTIFIED LAND CORNER RECORDATION

DESCRIPTION OF CORNER EVIDENCE FOUND, AND ORIGINAL RECORD (if known)

NONE

32	33
5	4

Location: SE Corner sec. 32

DESCRIPTION OF MONUMENT AND ACCESSORIES ESTABLISHED TO PERPETUATE THE ORIGINAL LOCATION OF THIS CORNER:

A No. 5 X 30 inch rebar was set in the intersection of traveled roadways and fenced rights-of-way after a complete search of the area revealed that the corner was lost. Reference data was established as shown in the sketch below.

SKETCH, WITH COURSE AND DISTANCE TO ADJACENT CORNER IF DETERMINED IN THIS SURVEY.
(May Sketch or Paste Reproduction on Reverse Side.)

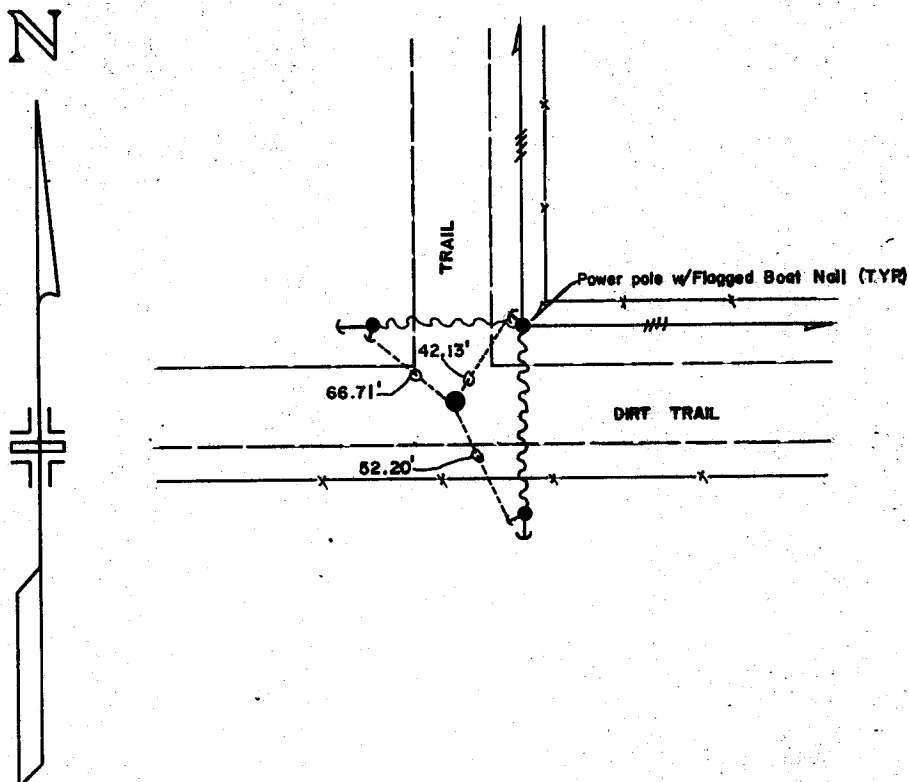

I, Floyd C. Curtis certify that I have carefully performed or reviewed the work done on the diagrammed corner as reported on this recordation form and approve the same.

Floyd C. Curtis
Signature of Surveyor

R. L. S. 317
Registration No.

STATE OF WYOMING,
Office of Clerk and Recorder,
County of Laramie

This "corner record" was filed for record on the 29 day of Sept, 1977, was noted on the cross-index plat and is assigned page No. _____, in book No. filed

County Official

Cross Index No. <u>7-9</u>	T. <u>17N</u>	R. <u>60W</u>	Mer. <u>6 PM</u>
_____	T. _____	R. _____	Mer. _____
_____	T. _____	R. _____	Mer. _____
_____	T. _____	R. _____	Mer. _____
_____	T. _____	R. _____	Mer. _____
_____	T. _____	R. _____	Mer. _____
_____	T. _____	R. _____	Mer. _____

122815

*Miner & Miner
Denver, Colo.*

7-9 17-60