

Wyoming Certified Land Corner Recordation Certificate

This form is to be completed in accordance with W.S. 36-11-101, printed in black ink or typed, and shall be for one individual corner.

Describe below, or show in sketch attached to this form, the corner evidence found. Include condition and type of monument, accessories and ties. Describe any maintenance or rehabilitation performed. In the circle to the right, show monument inscription. If monument is determined lost or obliterated, restate the GLO or BLM original field note record; describe or show the procedure used to reestablish the corner and all data as above for a found monument.

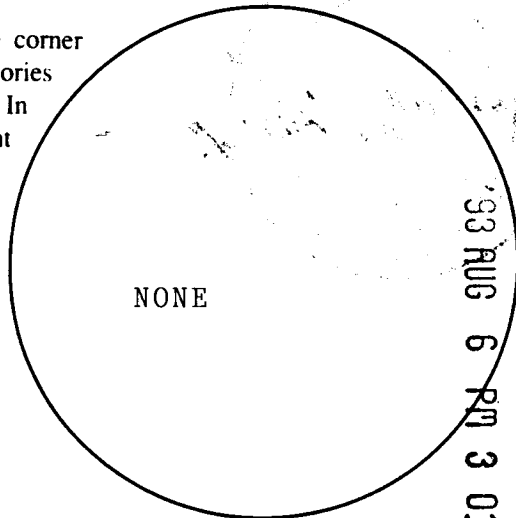

RECEIVED
 LARAMIE COUNTY
 CHEYENNE, WY.
 124495

Field Date _____ Office Reference _____

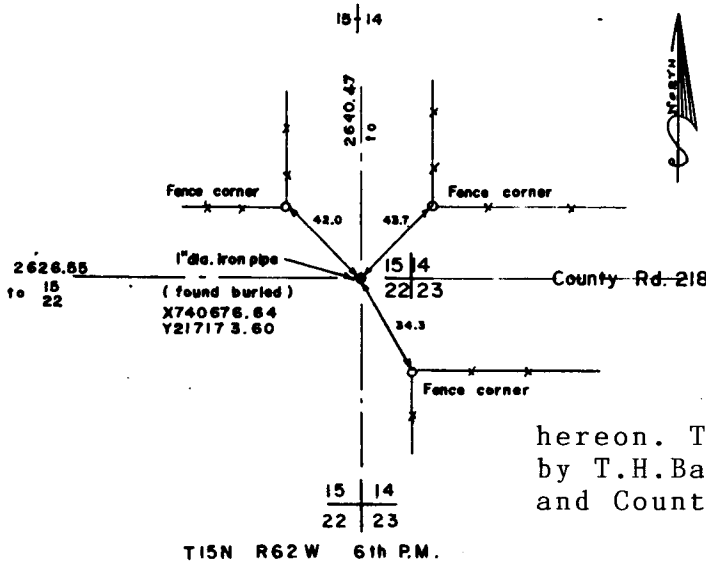

Monument Inscription

J.W. Hammond survey in the year 1872 performed under GLO contract, called for a 20x10x4 sand stone.
 A 1" dia. pipe was found in the center of co. rd. 218 as shown hereon. This monument was probably set by T.H. Baldwin, one time County Engineer and County Surveyor.

State of Wyoming

Office of County Clerk
 County of _____

This Certified Land Corner Recordation Certificate was filed for record on the _____ day of _____, 19 ____, in Book No. T _____, R _____, on Alpha-Numeric coordinates _____ and was noted on the Cross Index Plat.

County Clerk

Corner Type: Aliquot Corner Other
 Section(s) 15/14/22/23 Meridian 6th P.M.
 Corner Name 15 | 14 22 | 23 N-17 Township T15N Range R62W Page _____
 Sheet _____ of _____

**Directions for using the
Cross Index Plat**

Section, quarter and sixteenth corners will be marked with a dot at the corner location. The alpha-numeric coordinate number is then determined for the intersection of the two lines. A corner that applies to two or more townships shall be filed under all that apply by the use of photo copies.

Closing corners will be indexed under the township in which they control ownership. For 1/64, 1/256, 1/1024 and non-aliquot corners lying between grid designations, mark the appropriate grid area with a dot and use the index code to the north and west (local systems may be used if the method is approved by the County Surveyor or Clerk and a written description of its use is filed in the front of each book of certificates).

Cross Index Plat

	1	2	3	4	5	6	7	8	9	10	11	12	13	14	15	16	17	18	19	20	21	22	23	24	25
A																									
B																									
C																									
D																									
E																									
F																									
G																									
H																									
J																									
K																									
L																									
M																									
N																									
O																									
P																									
Q																									
R																									
S																									
T																									
U																									
V																									
W																									
X																									
Y																									
Z																									

State Plane Coordinates (optional)

Zone W . WC EC E feet/meters

NAD 1927 NGVD 1929 NAD 1983 NAVD 1988

North (Y) = 217173.60 East (X) = 740676.64 EL = 5470+/-

Latitude _____ Longitude _____

Scale Factor 1.000007344 Geoid Height _____

Certification

I, Larry T. Perry, Wyoming PES/PE L.S. 3047 certify that I, or others under my supervision, have performed the work as described above and completed this form.

Company or Agency Terrestrial Surveying & Mapping Co.

Mailing Address P.O. Box 82

Street Address 1127 Terry Ranch Road

City, State, ZIP Cheyenne, Wyoming 82003

Telephone, FAX (307) 634-9360

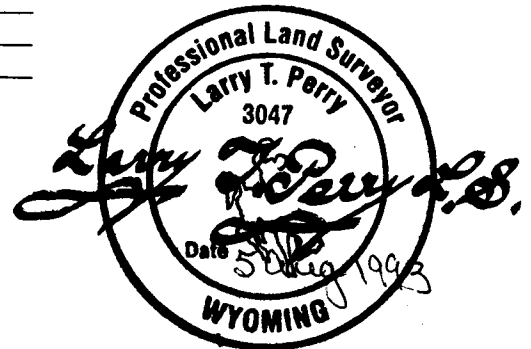

Signature, Seal, and Date

Sheet ___ of ___